

ACS PART NUMBER	G PILOT #	REF HOLE #	REF HOLE #	E # HOLES	NOTES	H DISK
296200	2.000/2.003	3.500	.406	6		7150002004635
296100	1.002/1.004	1.970	.343	4		71500010034194424
296256	2.562/2.565	3.500	.406	6	PILOT PER DETAIL *Y*	7150002564635
296325	3.250/3.253	3.810	.343	4		7150003253438
296161	1.614/1.617	2.500	.343	4		7150001613425
29610X	1.002/1.004	—	—	—		7150001000000
296400	4.000/4.003	4.478	.228	8		7150004002845

SEE PILOT LISTING P/N 999999 FOR ADDITIONAL PILOTS (E)

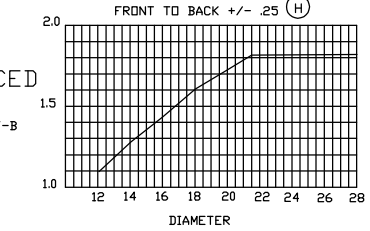

- NOTES:
- MATERIAL: B3WG6 OR PA6GF30 NYLON 6 GLASS FILLED 30%
 - BALANCE TO 4 OZ/IN. BALANCE TO BE ACHIEVED BY MATERIAL REMOVAL AT BLADE TIP UP TO .3 INCHES ON 4 BLADES OR BY ADDITION OF BALANCE WEIGHTS ON HUB RIBS.
 - A DASH NUMBER WILL BE INCLUDED DESIGNATING FAN DIAMETER (ØD). EX. 296200-28 (INCHES) OR 296200-711 (MM). THE MAX REFERENCE FAN DIA IS 28 INCHES AND 27 INCHES FOR FANS MOLDED AFTER 09DCT14. THE DIA TOLERANCE ON MOLDED FAN DIAMETERS IS +.150/- .236. THE DIA TOLERANCE ON CUT DIAMETERS IS +0/- .236.
 - NO DIAMETERS ALLOWED BETWEEN 26.5 INCHES AND AS MOLDED AS THERE IS NO METHOD TO CUT THE FAN IN PRODUCTION.
 - PW IS DEFINED AS THE MAXIMUM MEASUREMENT FRONT TO BACK.

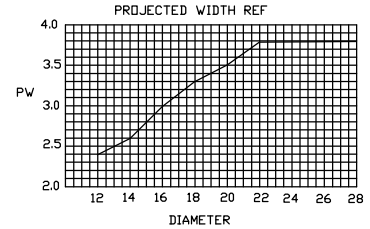
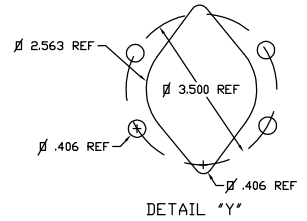
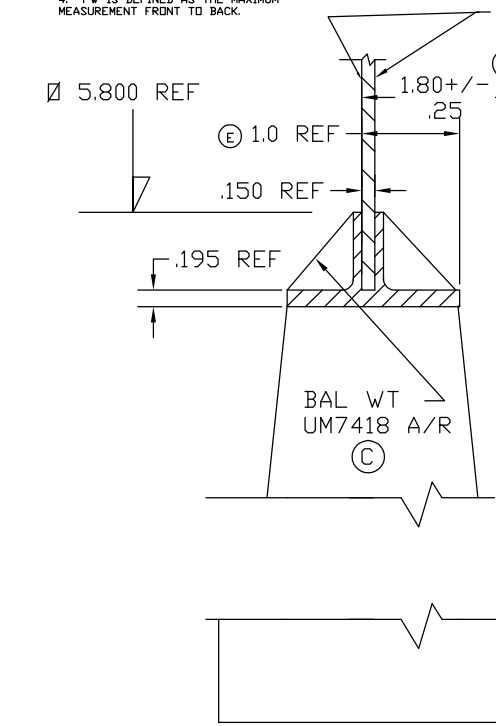

PART NO. EITHER SIDE

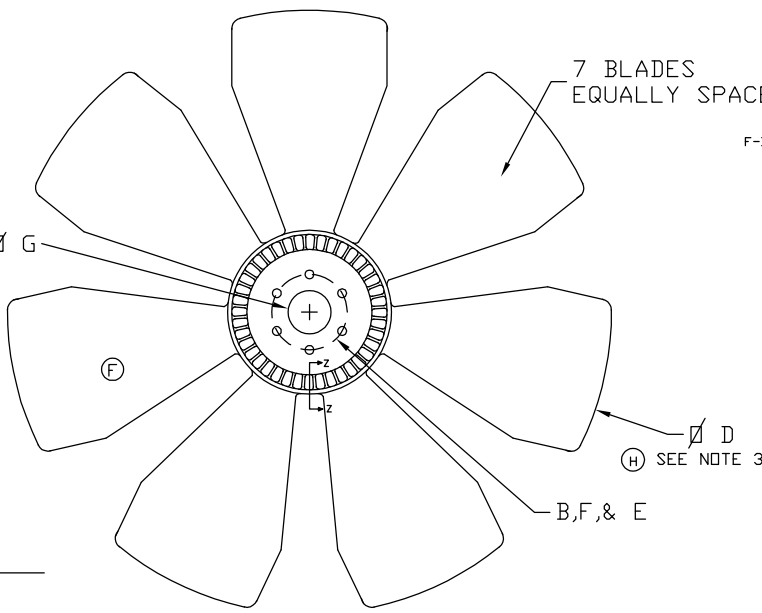

AIRFLOW

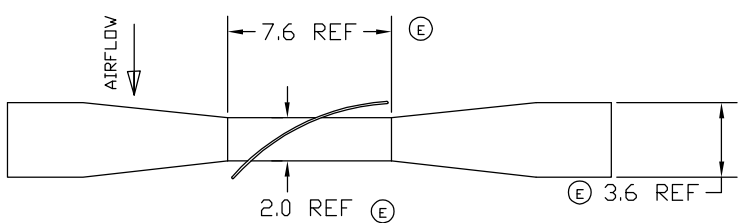

NOTE: BLADES REMOVED FOR CLARITY

REV	DESCRIPTION	DATE	BY
H 0081	ADD TOL TO F-B AND DIAMETER CLARIF.	28JUN16	GFS
G 0073	27 IN TOOL INTRODUCED	09OCT14	GFS
F 0046	CORRECT DWG	20DEC05	GFS
E 0045	MODIFY NOTE 3 AND ADD REF DIMS.	24DCT05	GFS
D 0019	ADD NOTE ON PILOTS	19MAR02	GFS
C 0018	ADD BALANCE WEIGHT P/N TO PRINT	20FEB02	GFS
B 0012	ADD 4.0 PILOT	01SEP00	GFS
A 0008	RELEASED	14MAR00	GFS
SYM ECN	REVISION	DK'D	DATE



PART NAME
FAN ASSEMBLY - 296

DRAWN GFS	APPROVED
DATE 10SEPT99	SCALE 1/4
MATERIAL NOTED	ENGR G. SPRINGMAN
SHRINK .05 IN/IN	QC
FINISH NOTED	NFG

THIS DRAWING HAS BEEN PROVIDED IN ACCORDANCE WITH ADP 1453H-1994	CUSTOMER
	CUSTOMER PART NO.
TOL UNLESS SPECIFIED XXX +/- .005 XX +/- .002 X +/- .001 < 1/2 - 1	ACS PART NO. 296XXX